

CLIENT:

ORD 11976

CDM Regulations - Design Risk Assessment

The size and shape of individual stones for this project have been designed to satisfy the overall design requirements for the building, bill of quantities or specific project specification.

All persons handling and installing such stones should be aware that there are risks associated with this type of work, which cannot be designed out.

Limestones & Marble are a natural material and may vary in texture, color and veining intensity. Please consider a dimensional tolerance of $\frac{1}{8}$ "

Important: All modular stone/marble fireplace's primary fix must be on a structural brick or block wall using a suitable high bond adhesive. In all instances, these must also be securely mechanically fixed.

© CHESNEYS 2022

CHESNEYS

HEAD OFFICE:
194-196 BATTERSEA PARK ROAD, BATTERSEA, LONDON
TELEPHONE: +44 (0) 20 7627 1410
WEB SITE: WWW.CHESENEYS.CO.UK
E MAIL: SALES@CHESNEYS.CO.UK

SURROUND:

LUNA BOLECTION

AREA:

MATERIAL:

FINISH:

HONED AND WAXED

NOTES:

MANTEL WEIGHTS:

JAMB / EACH: 74KG - 164LB
HEADER: 124KG - 274LB
TOTAL: 272KG - 600LB

MANTEL M3:

JAMB / EACH: 0.0274M3
HEADER: 0.0459M3
TOTAL: 0.1007M3

DRAWN BY:

JC

DATE:

12/06/2024

SCALE:

1:8 @ A3

INVOICE NUMBER:

US1ORD0011976

DRAWING NO.:

10563 JC

REV:

5

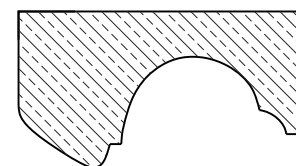
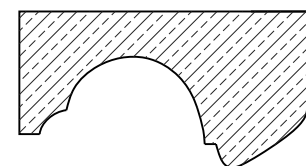
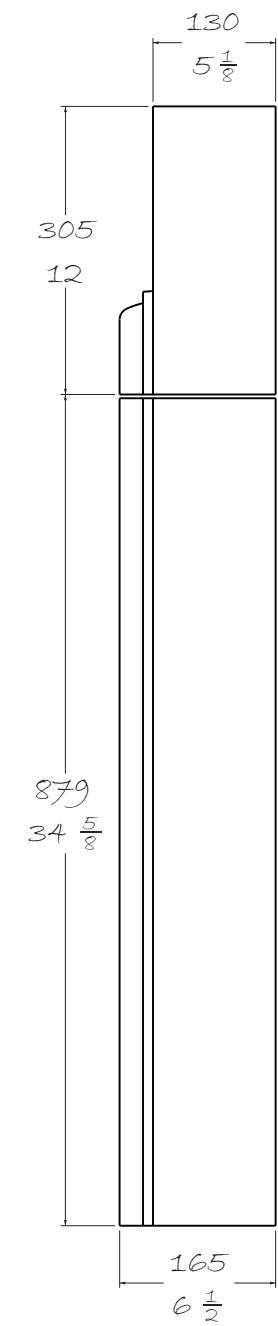
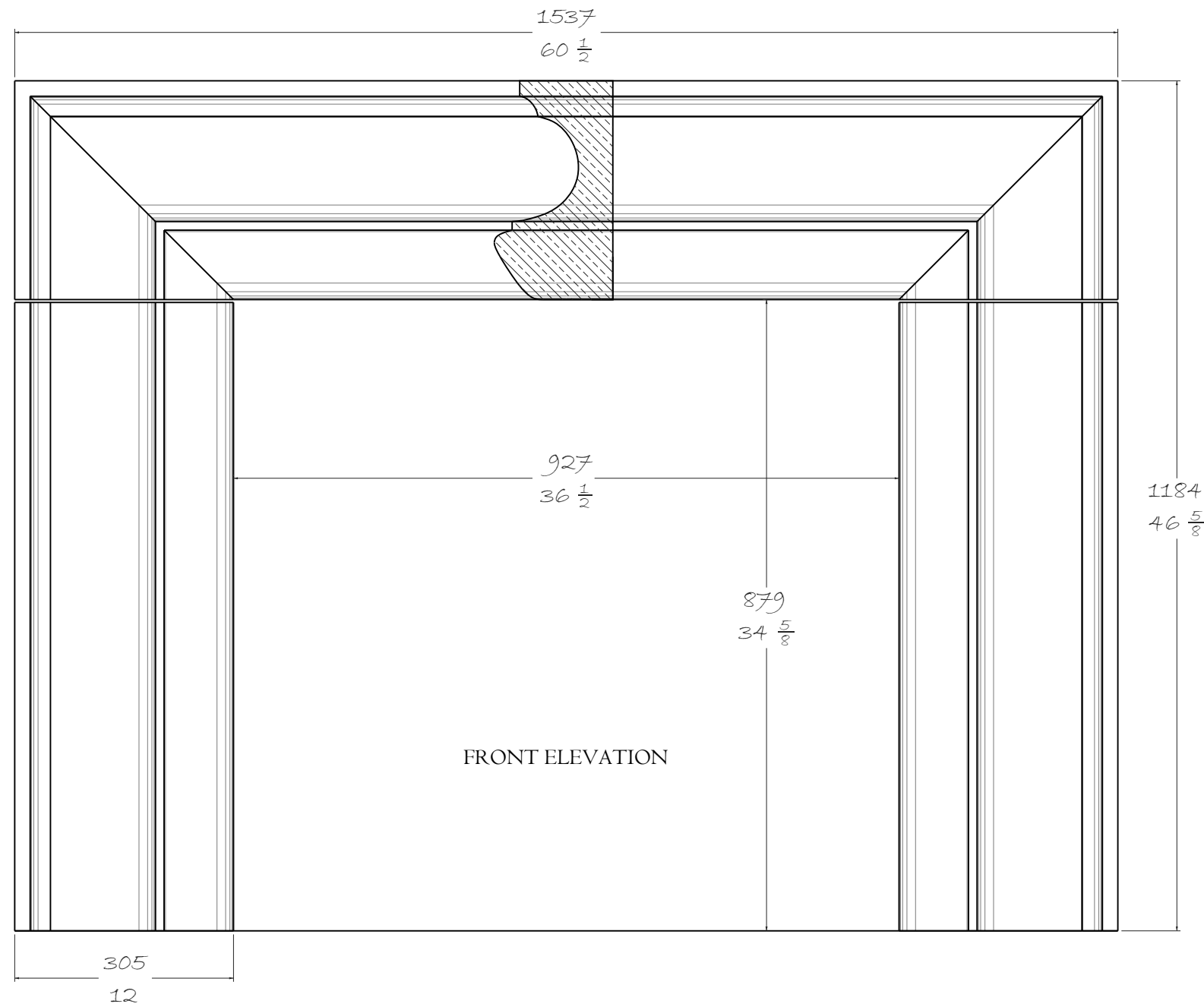

CLIENT:

SHOPHOUSE DESIGN

CDM Regulations - Design Risk Assessment

The size and shape of individual stones for this project have been designed to satisfy the overall design requirements for the building, bill of quantities or specific project specification.

All persons handling and installing such stones should be aware that there are risks associated with this type of work, which cannot be designed out.

Limestones & Marble are a natural material and may vary in texture, color and veining intensity.

Please consider a dimensional tolerance of $\frac{1}{8}$ "

Important: All modular stone/marble fireplace's primary fix must be on a structural brick or block wall using a suitable high bond adhesive. In all instances, these must also be securely mechanically fixed.

© CHESNEYS 2022

CHESNEYS

HEAD OFFICE:
194-196 BATTERSEA PARK ROAD, BATTERSEA, LONDON
TELEPHONE: +44 (0) 20 7627 1410
WEB SITE: WWW.CHESENEYS.CO.UK
E MAIL: SALES@CHESNEYS.CO.UK

SURROUND:

LUNA BOLECTION

AREA:

MATERIAL:

ARABESCATO

FINISH:

HONED AND WAXED

NOTES:

MANTEL WEIGHTS:

JAMB / EACH: 74KG - 164LB
HEADER: 124KG - 274LB

TOTAL: 272KG - 600LB

MANTEL M3:

JAMB / EACH: 0.0274M3
HEADER: 0.0459M3

TOTAL: 0.1007M3

DRAWN BY:

JC

DATE:
12/06/2024

SCALE:
1:8 @ A3

INVOICE NUMBER:

US1ORD0011976

DRAWING NO.:
10563 JC

REV:
5

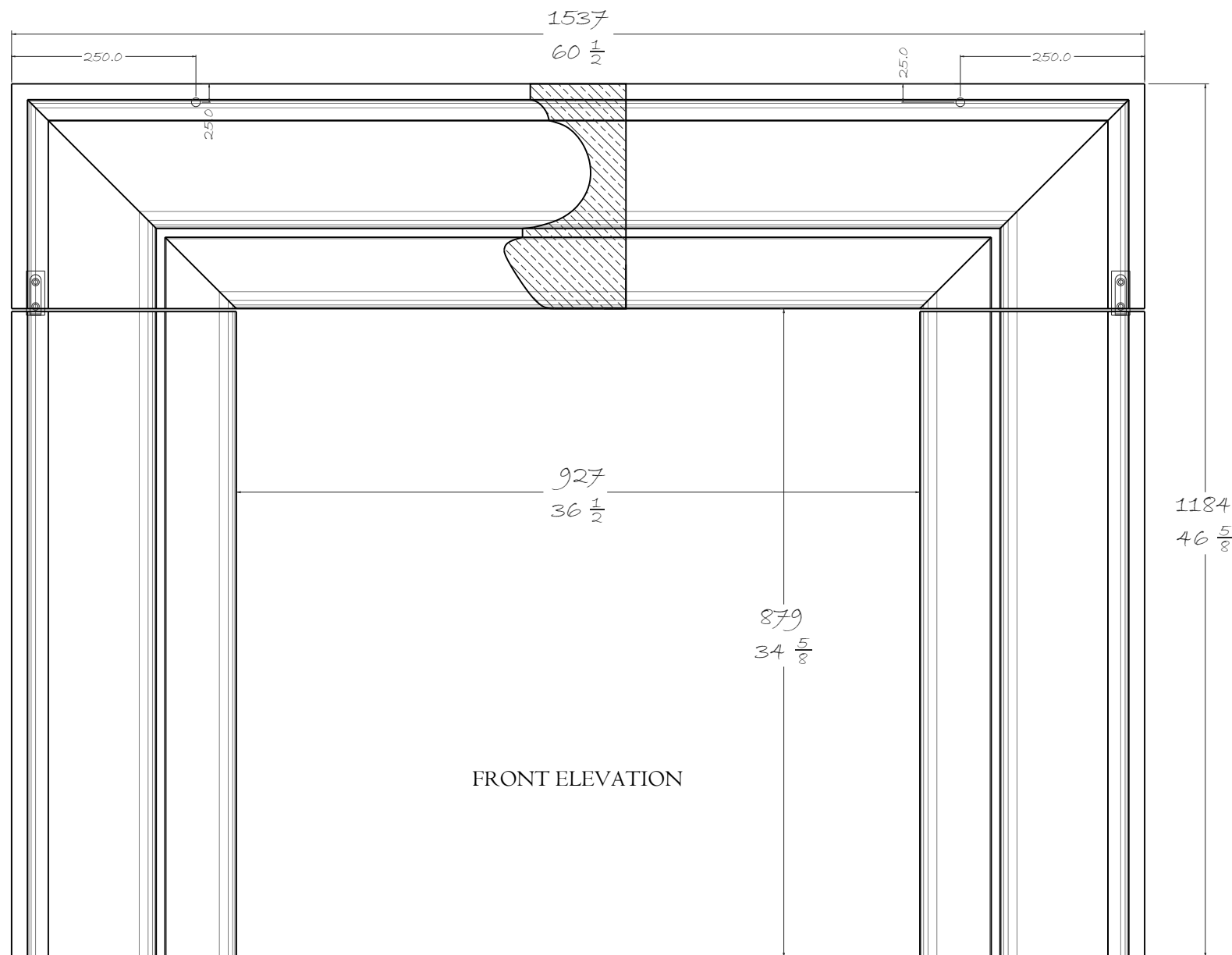

FRONT ELEVATION

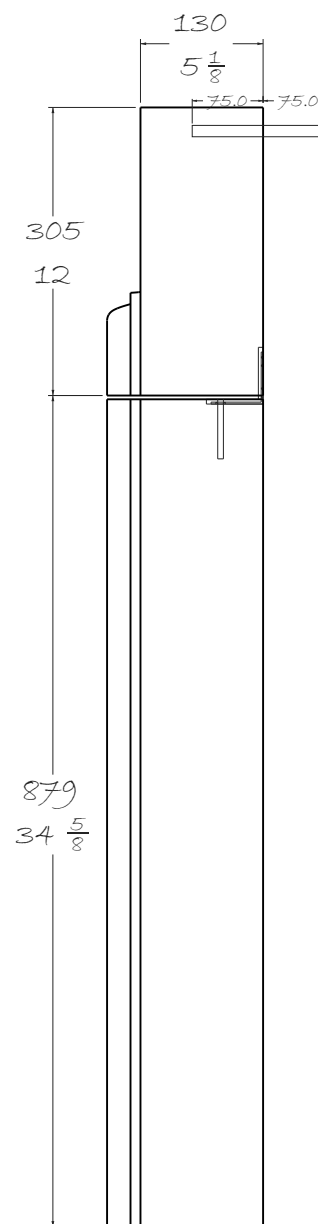

SIDE ELEVATION

BRACKETS & DOWELS CHART



X 2 PIECES



X 2 PIECES
(175 MM X 12 MM)

5 mm recess
to take bracket

6 mm hole
60mm deep

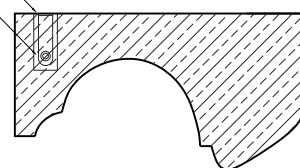

PLAN

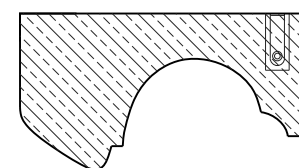

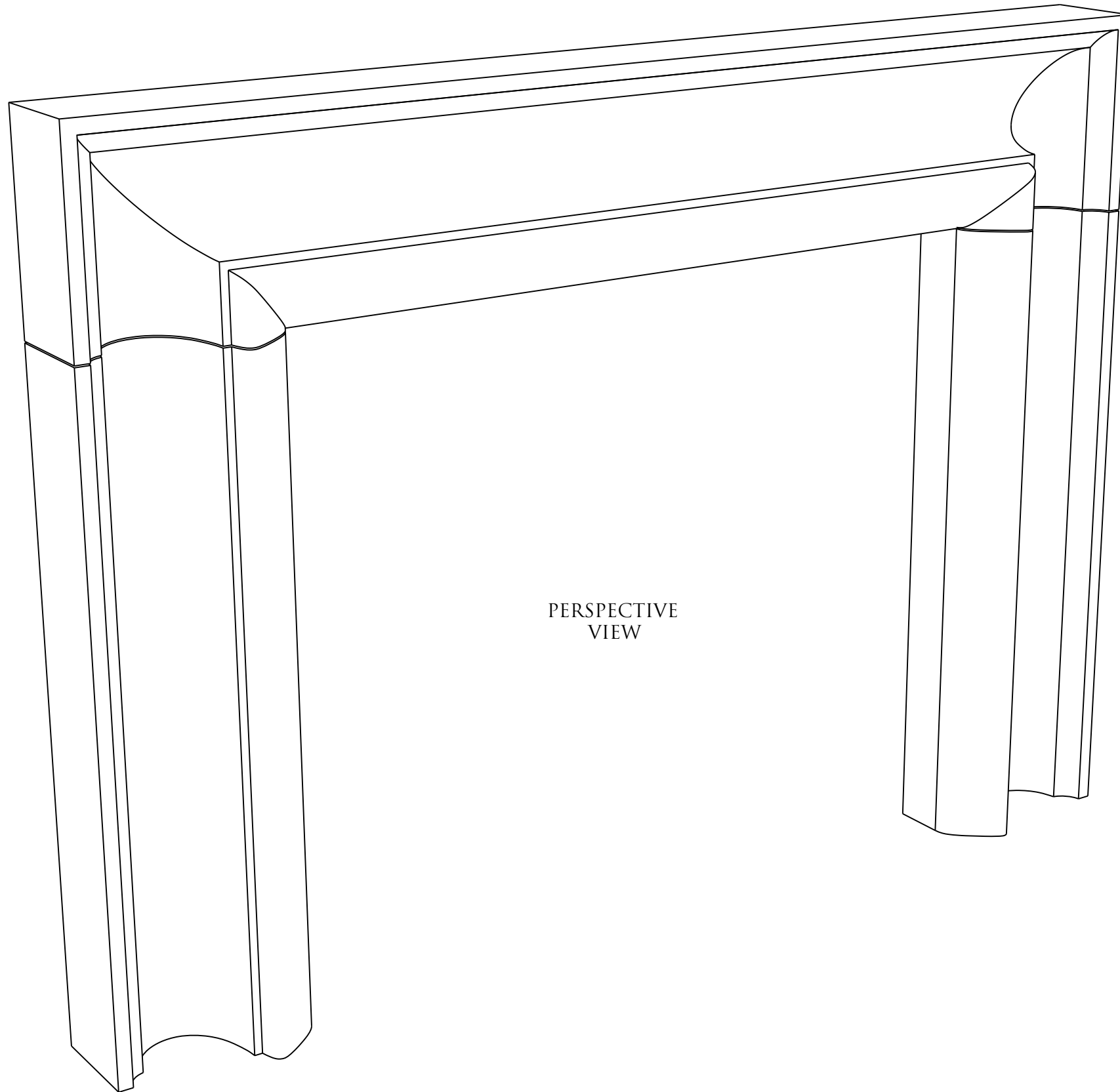

PERSPECTIVE
VIEW

CLIENT:

SHOPHOUSE
DESIGN

CDM Regulations - Design Risk Assessment

The size and shape of individual stones for this project have been designed to satisfy the overall design requirements for the building, bill of quantities or specific project specification.

All persons handling and installing such stones should be aware that there are risks associated with this type of work, which cannot be designed out.

Limestones & Marble are a natural material and may vary in texture, color and veining intensity.

Please consider a dimensional tolerance of $\frac{1}{8}$ "

Important: All modular stone/marble fireplace's primary fix must be on a structural brick or block wall using a suitable high bond adhesive. In all instances, these must also be securely mechanically fixed.

© CHESNEYS 2022

CHESNEYS

HEAD OFFICE:
194-196 BATTERSEA PARK ROAD, BATTERSEA, LONDON
TELEPHONE: +44 (0) 20 7627 1410

WEB SITE: WWW.CHESENEYS.CO.UK
E MAIL: SALES@CHESNEYS.CO.UK

SURROUND:

LUNA BOLECTION

AREA:

MATERIAL:

ARABESCATO

FINISH:

HONED AND WAXED

NOTES:

MANTEL WEIGHTS:

JAMB / EACH: 74KG - 164LB
HEADER: 124KG - 274LB

TOTAL: 272KG - 600LB

MANTEL M3:

JAMB / EACH: 0.0274M3
HEADER: 0.0459M3

TOTAL: 0.1007M3

DRAWN BY:

JC

DATE:

12/06/2024

SCALE:

1:8 @ A3

INVOICE NUMBER:

US1ORD0011976

DRAWING NO.:

10563 JC

REV:

5